



Operating Instructions

Model 37208

Hydrostatic Test Pump



Specifications

DIMENSIONS:	33" L x 19" W x 18"H
WEIGHT:	225 lbs 102.5 kg
PUMP:	<p>Triplex Plunger: Positive Displacement Inlet: ¾" Garden Hose Outlet: ½" NPT Capacity: 3.5gpm / 13.25 lpm Pressure: 0 – 3000psi, 0-200 bar Operating Speed: 1725rpm Lubrication: Continuous oil bath 23.66 oz Special Cat Pump Oil Shaft Size: 1" solid</p>
MOTOR:	<p>7.5 hp 208-230V, 3 phase, 60hz, 21.5 amps 460V, 3 phase, 60hz, 10 amps</p>
CONTROL:	Adjustable pressure relief valve
GAUGE:	Glycerin filled, 0-4000psi
DISCHARGE HOSE:	½" x 10' (3m), 5000psi



WHEELER-REX LIMITED LIFETIME WARRANTY

WHEELER-REX covers its products with a Limited Lifetime Warranty, with exception of pipe threading machines which have a Limited Three Year Warranty (including electric motors). Warranties from manufacturers of components used in our products may pre-empt the Wheeler-Rex warranty. Wheeler-Rex warranties against defects in material or workmanship. To take advantage of this warranty, the complete product must be delivered prepaid to Wheeler-Rex or any WHEELER-REX AUTHORIZED SERVICE CENTER. No tools are to be returned to the factory without receiving prior authorization. Obviously, failures due to misuse, abuse, or normal wear and tear are not covered by this warranty. **NO OTHER WARRANTY, WRITTEN, OR ORAL, APPLIES. THERE ARE NO WARRANTIES WHICH EXTEND BEYOND THE DESCRIPTION ON THE FACE HEREOF.** No employee, agent, dealer, or other person is authorized to give any warranty on behalf of Wheeler-Rex. Warranted products will be repaired or replaced at our option, at no charge and returned to you via prepaid transportation. Such replacement or repair is the exclusive remedy available from Wheeler-Rex. Wheeler-Rex is not liable for damage of any sort, including incidental and consequential damages. Some U.S.A. states do not allow the exclusion or limitation of incidental or consequential damages, so the above limitation or exclusion may not apply. This warranty gives you specific legal rights, and you may also have other rights which vary from state to state.

Form # 1031

WARNING

GENERAL TOOL OPERATION WARNINGS

FOR ALL TOOLS-

1. **Keep Guards in Place** and in working order.
2. **Remove Adjusting Keys and Wrenches** from tool before turning it on.
3. **Keep Work Area Clean.** Cluttered areas and benches invite accidents.
4. **Avoid Dangerous Environment.** Don't use power tools in damp or wet locations. Keep work area well lit. Don't expose power tools to rain.
5. **If you must use an electric tool** in a damp or wet location; make sure it is plugged into a circuit which is protected by a ground fault interrupt.
6. **Keep Children Away. ALL VISITORS SHOULD BE KEPT A SAFE DISTANCE FROM WORK AREA.**
7. **Store Idle Tools** in dry, high, or locked-up place out of reach of children.
8. **Don't Force Tool.** It will do a better and safer job at the rate for which it is designed.
9. **Use Right Tool.** Don't force a small tool or attachment to do the job of a heavy-duty tool.
10. **Wear Proper Apparel.** No loose clothing or jewelry to get caught in moving parts. Rubber gloves and footwear are recommended when working outdoors.
11. **Use Safety Glasses.**
12. **Don't Abuse Cord.** Never carry tool by cord or yank it to disconnect from receptacle. Keep cord from heat, oil, and sharp edges.
13. **Secure Work.** Use clamps or vise to hold work when practical. It's safer than using your hand and it frees both hands to operate tool.
14. **Don't Overreach.** Keep proper footing and balance at all times.
15. **Maintain Tools Properly.** Keep tools sharp and clean for best and safest performance. Follow instructions for lubricating and changing accessories. Equipment operators must have proper maintenance & instruction sheets. Be sure the tool operator reads and understands this information. If you don't have current maintenance and instruction sheets, contact the factory & we will supply them at no charge.
16. **Disconnect Tools** when not in use; before servicing; when changing accessories such as dies, cutters, etc.
17. **Avoid Accidental Starting.** Don't carry plugged-in tool with finger on switch. Be sure switch is off when plugging in.
18. **Outdoor Use Extension Cords.** When tool is used outdoors, use only extension cords suitable for use outdoors and so marked.
19. **Wear Ear Protection** if exposed to long periods of very noisy shop operations.
20. **Do not operate tools** while under the influence of alcohol, drugs or medication.



Operating Instructions

Model 37208

Hydrostatic Test Pump

Parts

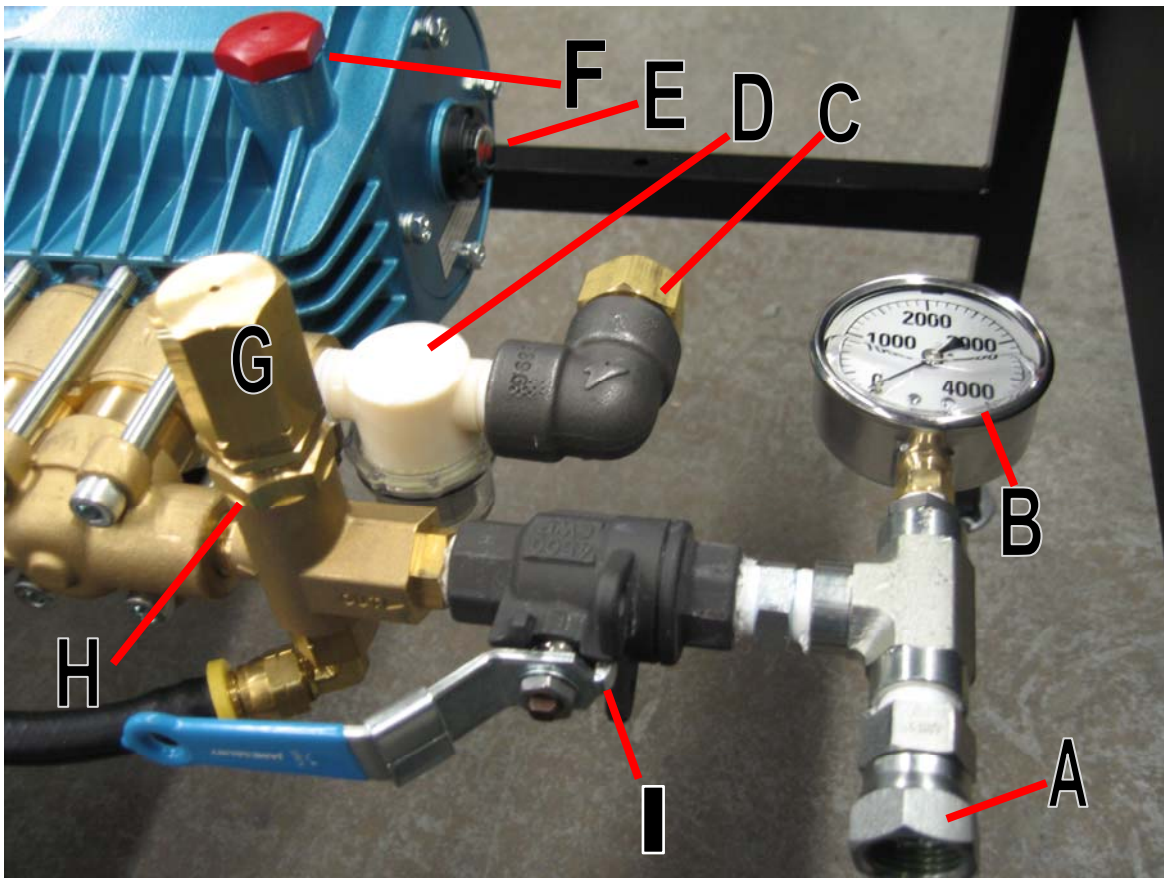

A	Output Connection
B	Gauge
C	Inlet Connection
D	Strainer
E	Sight Glass
F	Oil Cap
G	Pressure Relief Valve Knob
H	Jam Nut
I	Ball Valve



Operating Instructions

Model 37208

Hydrostatic Test Pump

Parts . . . continued



Motor Start/Stop Switch



Operating Instructions

Model 37208

Hydrostatic Test Pump

Pressure Feed (or Gravity Feed) Method: (Preferred Methods)

1. Fill the water line (or test vessel) to be tested prior to pump connection.
2. Connect water supply hose to the garden hose inlet connection (C) on the pump.
3. Open valve and turn water supply on.
4. Purge the pump and pressure hose of all air.
5. Connect output (pressure) hose between pump output connection (A) and water line (or vessel) being tested.
6. Turn pump on.
7. Purge water line (or vessel) of all air at the highest point of the system.
8. Bring water line (or vessel) to pressure. Watch the gauge (B) while pumping. When the desired pressure is achieved, turn the isolation valve (I) to the "off" position. The engine can now be turned off. If pressure drops, there is a leak in the line.

Siphon Method

Use a clean water source

1. Fill the water line to be tested.
2. Fill the intake hose (WR PN #34550) with water, then quickly place the hose into a bucket and turn pump on. (The unit is self-priming once primed.) Continue to pump until you see the water coming out of the outlet, with little or no air mixed with it.
3. Connect the output hose to the water line. Continue on with steps 6 through 8 in pressure feed method.

Pre-Setting Your Pump

Your pump can be pre-set to a specific pressure easily by adjusting the pressure relief valve.

1. Unscrew (counterclockwise direction) pressure relief valve knob (G) a few turns. Be sure not to unscrew valve knob all the way as internal parts can be easily lost.
2. Add a ball valve (not supplied with pump) to the end of the high pressure hose.
3. Follow steps 2 through 4 from the 'Pressure Feed Method'.
4. As water is flowing out of the high pressure hose, turn the ball valve to the "off" position.
5. Slowly start turning pressure relief valve knob (G) (in the clockwise direction) by $\frac{1}{4}$ turn increments, until you reach the desired pressure. Maximum pressure is 3000psi. Tighten jam nut (H) to lock pressure relief knob in place.
6. Your test pump is now pre-set. This eliminates over-pressurizing the water line (or the vessel).



Operating Instructions

Model 37208

Troubleshooting Your Pump

Test pressure not being reached:

- Possible air in line (or vessel)
 - ◊ Air needs to be purged from system.
 - ◊ Remove pump from system and follow steps 1 thru 6 of the "Pre-Setting Your Pump" section.
 - ◊ If using the Siphon Method and not getting pressure, try the 'Pressure Feed' or 'Gravity Feed Method' to ensure water is getting into the pump.
 - ◊ Check strainer (D) O-Ring for cracks.
 - ◊ Check inlet quick disconnect (C) O-Ring for cracks
- Pressure relief valve not adjusted properly.
 - ◊ Turn relief valve counterclockwise and watch for change in pressure.

Pump Maintenance

- Pump 50/50 antifreeze/water solution through pump after each use to lubricate internal parts of pump and to avoid freezing in cold weather.
- Check strainer O-Ring (D) for cracks prior to each use.
- Check oil level through oil sight glass (E) located on front of pump prior to each use. CAT recommends changing oil after 50 hours of break-in operation. Change oil every 3 (three) months or after 500 hours of use. Pump requires CAT pump crankcase oil (21oz container), Wheeler Rex PN 276254. Add oil through pump crankcase cap (F).
- Suction Hose Wheeler Rex PN 34550

CAUTION !!!

This pump is designed for water only!!

The pump is equipped with an adjustable pressure relief valve (G), which helps protect the system from being over pressurized. It can be preset by plugging the end of the hose. Turn the adjusting knob clockwise to increase pressure and counterclockwise to decrease.



Operating Instructions Model 37208 Hydrostatic Test Pump

Maintenance



- Lube motor per manufacturer's specs
- Rotation Sticker - turn pump on to check motor rotation. Correct rotation is important for proper pump lubrication and max pump life.
- Due to 3-phase wiring, check for proper motor rotation before each use.

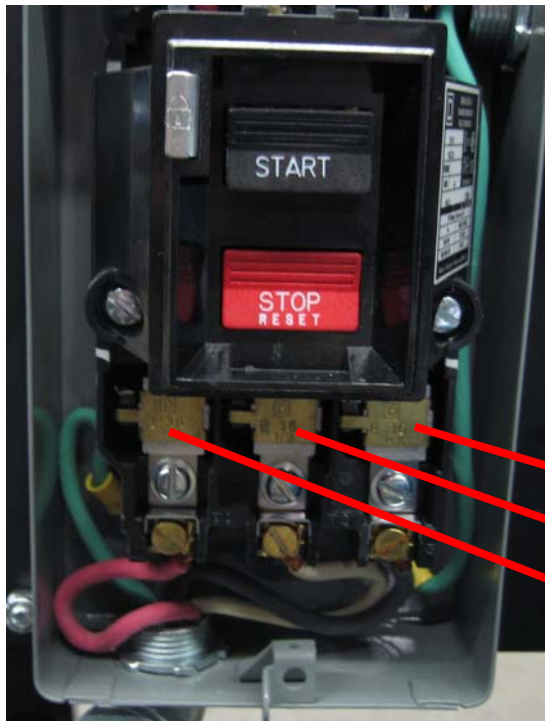

Problem:

Motor will not run when turned on

Fix:

Check for "blown" thermal unit.

Thermal Units
Wheeler Rex PN 276387

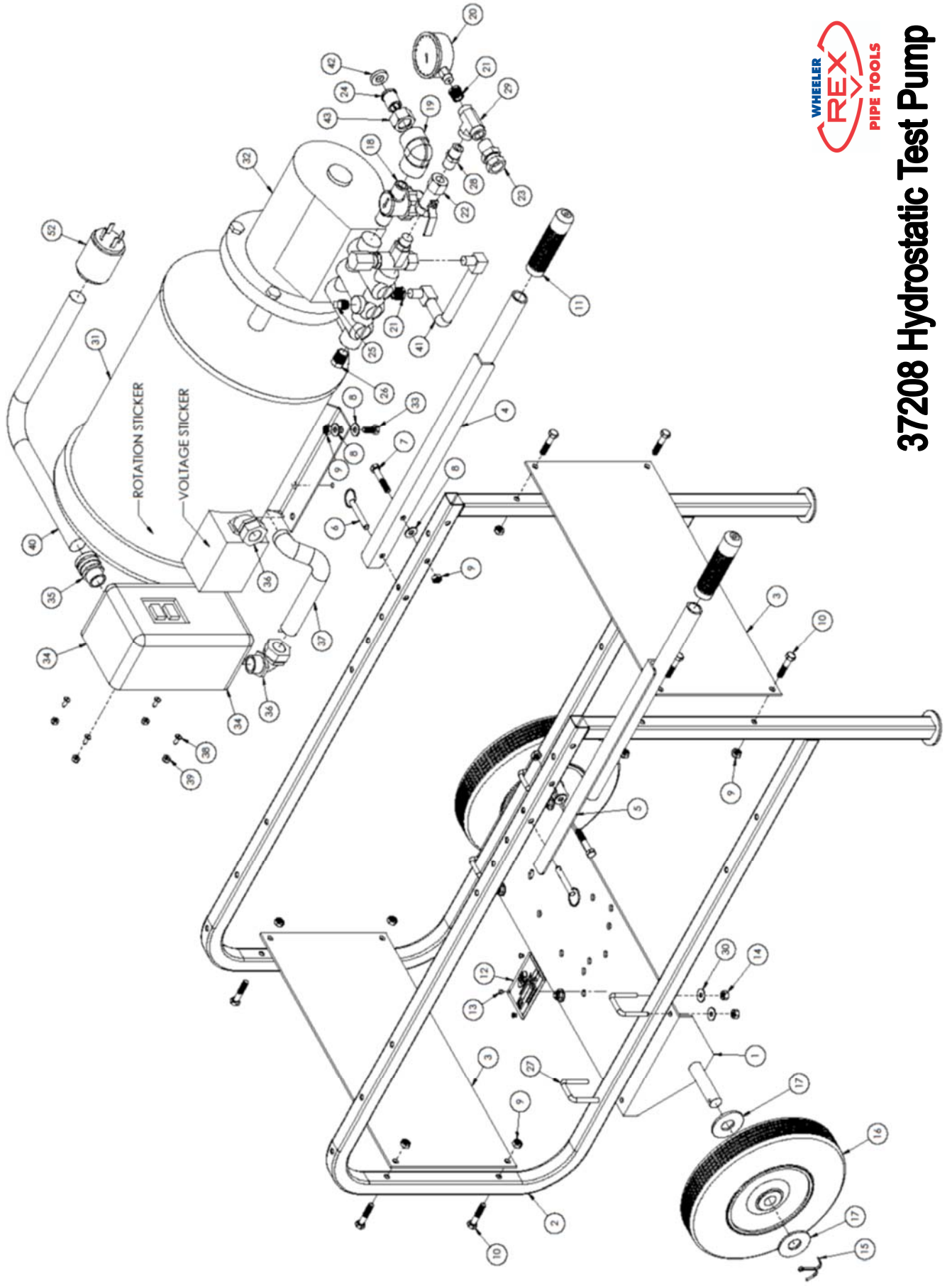

37208 Hydrostatic Test Pump

Item No	Part No	Description	Qty
1	700943	AXLE ASSEMBLY	1
2	700387	CART SIDE	2
3	700958	END PLATE	2
4	700858	RIGHT HANDLE ASSEMBLY	1
5	700859	LEFT HANDLE ASSEMBLY	1
6	276752	COTTERLESS PIN W/RING	2
7	275639	5/16-18 x 1 3/4" HHCS	2
8	275685	5/16" FLAT WASHER	10
9	275857	5/16-18 HEX NYLON INSERT LOCKNUTS	14
10	275638	5/16 x 1 1/2" HEX HEAD CAP SCREW	8
11	154	GRIP	2
12	220874	NAME PLATE	1
13	275543	POP RIVET, STAR 4-2AAD	4
14	275426	1/4-20 ESNA STOP NUT	8
15	276330	1/8 x 2 5/16 COTTER PIN	2
16	276441	THREADER CART WHEEL	2
17	276129	3/4" WASHER	4
18	276420	STRAINER ASSEMBLY	1
19	275697	1/2" 3000LB FS SCR D 90 ELL	1
20	276375	GAUGE, 4000psi	1
21	5613	3/8" to 1/4" HEX REDUCING BUSHING	2
22	276798	1/2" BALL VALVE	1
23	276345	3/8 NPT x 1/2 HOSE SWIVEL ADAPTER	1
24	275918	SWIVEL ADAPTER	1
25	276468	1/4" PIPE PLUG	1
26	275768	3/8" HEX HEAD PLUG	1
27	700406	U-BOLT	4
28	276801	3/8 HYDRAULIC NIPPLE	1
29	276800	TEE	1
30	276540	1/4" FLAT WASHER	8
31	277184	MOTOR	1
32	276789	PUMP	1
33	166	5/16-18 x 3/4 HEX HEAD CAP SCREW	4
34	276388	STARTER BOX	1
35	275189	CORD GRIP	1
36	276390	PLUG 220V	2
37	276389	90 DEG ELE. SEAL TITE	2
38	700954	SEALTIGHT	1
39	275004	#10-24 PAN HEAD MACHINE SCREW	4
40	275708	#10-24 HEX NYLON INSERT LOCKNUTS	4
41	700657	POWER CORD	1
42	275915	BYPASS HOSE	1
43	275941	HOSE WASHER	1
44	275925	SWIVEL NUT	1
45	277181	WARNING TAG ***NOT SHOWN***	1
46	220577	PRESSURE HOSE ***NOT SHOWN***	1
47	34550	SUCTION HOSE ***NOT SHOWN***	1
48	276723	TERMINAL ***NOT SHOWN***	5
49	276782	TERMINAL ***NOT SHOWN***	3
50	276387	THERMAL UNIT ***NOT SHOWN***	3
51	276601	WIRE NUT ***NOT SHOWN***	3
52	276421	ELECTRICAL LOCKNUT ***NOT SHOWN***	1



Wheeler-Rex • Ashtabula, Ohio
Tel: 800-321-7950 or 440-992-2925 • Fax: 440-992-2925
wheeler@wheelerrex.com • www.wheelerrex.com